

SM Series - SIMM Sockets

1,27mm pitch



SIMM sockets are made of hi-temp resistant LCP.

Single row types are available in vertical and slanted version (26°).

Insertion & extraction of the module can be made without any tools.

Positive polarization prevents wrong insertion of the module.

Contacts are designed with an anti-overstress feature.



Single row - vertical

Standard Type

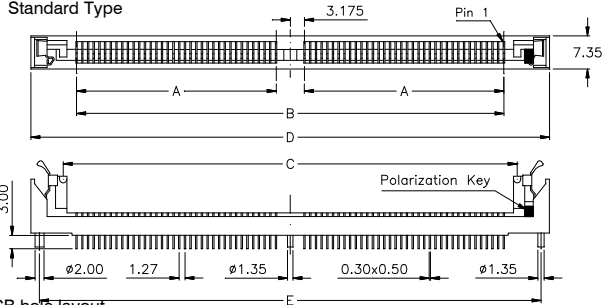

PCB hole layout

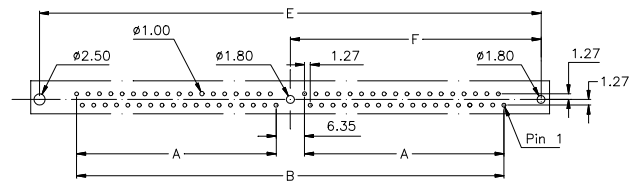

Reverse Type

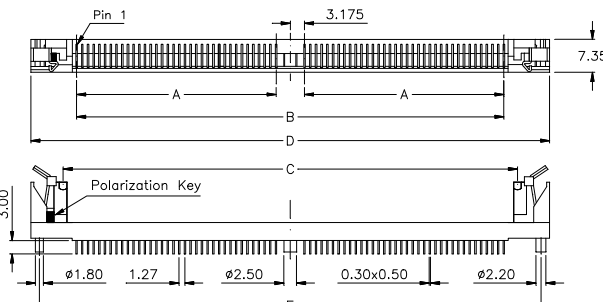

PCB hole layout

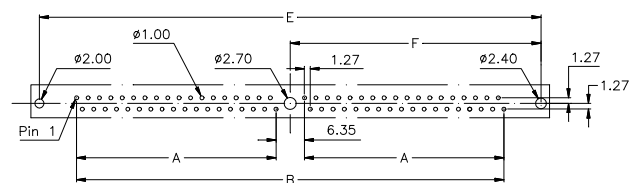

Specifications

Current rating	: 1 A max., 100V
Contact resistance	: 30 mΩ max.
Breakdown voltage	: 1,5 KV RMS max.
Insulation resistance	: 10 ⁴ MΩ min.
Capacitance	: 2 pF max.
Contact force	: 2 N min. (Module: 1.19mm to 1.37mm thick)
Operating temperature	: -55 °C to + 150 °C min.
Insulator (RoHS compliant)	: high temp plastic (ivory) UL 94 V-0
Contact (RoHS compliant)	: Phosphor bronze
Plating	: Sn (leadfree) over Ni

Single row - 26° slanted

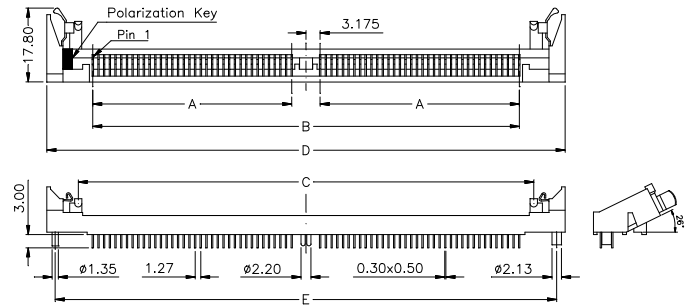

PCB hole layout

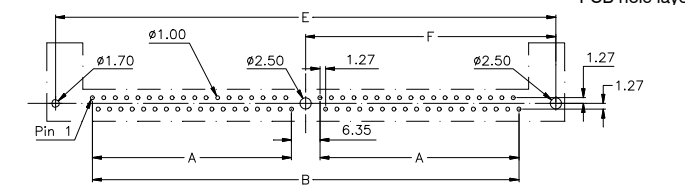

Dimensions for 1,27mm pitch SIMM Modules

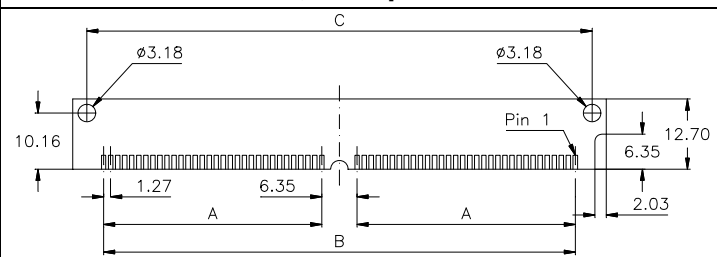

Ordering Code

Dimensions mm

||
||
||